

SuperCube Rectangular 380 x 265 mm 17 ltr

Product no: 6173
Shape: Rectangular
Available lids: 6171 (Standard)
 6172 (Special)

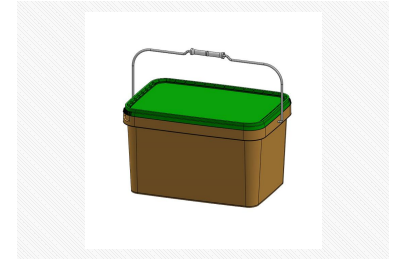

VOLUME

Volume under lid: 17.3 l ± 200 ml Volume brimful: 18 l ± 200 ml

DIMENSIONS

External length top: 380 mm ± 3.8 mm External width top: 265 mm ± 1 mm
 Length bottom: 339.5 mm ± 3.4 mm Width bottom: 224.5 mm ± 1 mm
 Height: 226 mm ± 1 mm

WEIGHT

Weight: 505 g ± 15 g Weight metal handle: 109 g ± 5 g

PERFORMANCE

Stackability - dynamic: Max: 37 kg top load on bottom container at 23°
Stacking tests The stacking tests have been performed to the standard virgin raw material as stated below at 23°C over a period of 2 months. Stackability depends on many factors and the above data is meant as an indication only. Consequently, customers should make internal trials to determine the viability of stacking and transportation.

CLOSURE SYSTEM

Lid type options: Standard, Special
 Closure type: Peel-off
 Protective collar: Yes
 Tamper Evidence type: Tamper Evidence lid

HANDLE

Standard handle: Metal with roller grip

DECORATION

Decoration available: IML

RAW MATERIAL

Raw material options: PP
 Masterbatch colours: Colours according to Superfos standard selected pantone colours.
Hot temperatures: The material chosen has a very good heat resistance and the packaging is suitable for hot filling. Notably, plastic packaging become flexible when subjected to hot filling temperatures and care must be taken in relation to stacking immediately after hot filling. The Superfos packaging must be tested by the customer with the actual product before approval for use at hot temperatures.
Cold temperatures: Freezing conditions require special resins available on request. The Superfos packaging must be tested by the customer with the actual product before approval for use at low temperatures.

QUALITY SPECIFICATIONS

Approvals: All Superfos Products comply with the European Union Commission Regulation No. 10/2011/EC with amendments, relating to materials and articles intended to come into contact with food, unless otherwise stated. In accordance with EU legislation, it is the responsibility of the customer to ensure that the supplied product is suitable for the intended use.
Shelf life: The compliance of the product to the technical specifications in this data sheet is guaranteed for 12 months after the date of the delivery subject to suitable storage. Suitable storage include protection of e.g. direct sun light, rain, very low temperatures or very high temperatures over a long period.
Quality information: Deviations in the product specifications in this data sheet of 0.025% or less (i.e. 25 items per 100,000) are considered acceptable in the industry and therefore cannot be construed as a defect. Also, please refer to the Standard Sales and Delivery Terms in force at the time of delivery.